

Identification field (laser engraving)
Font size: 2.5mm
content:

709-190
7.2V
WW/YY
ET 709-090

WW = Week
YY = Year

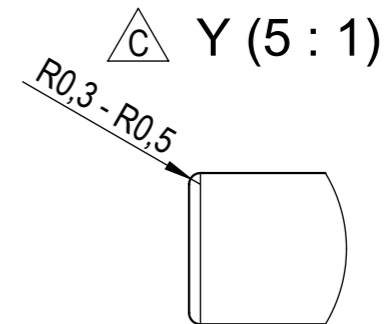
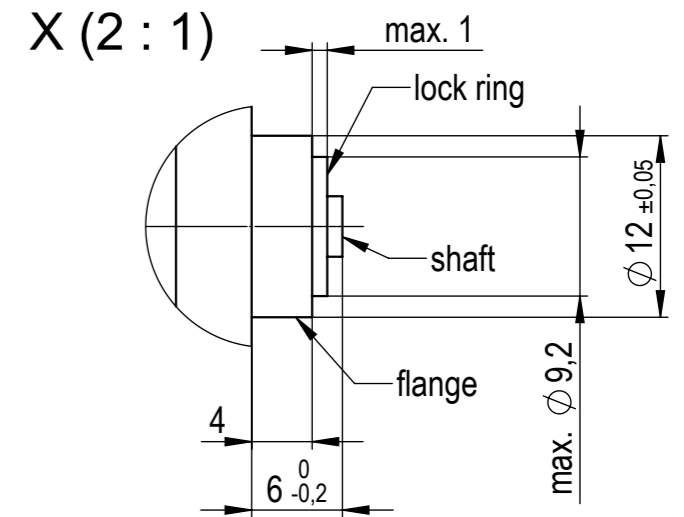
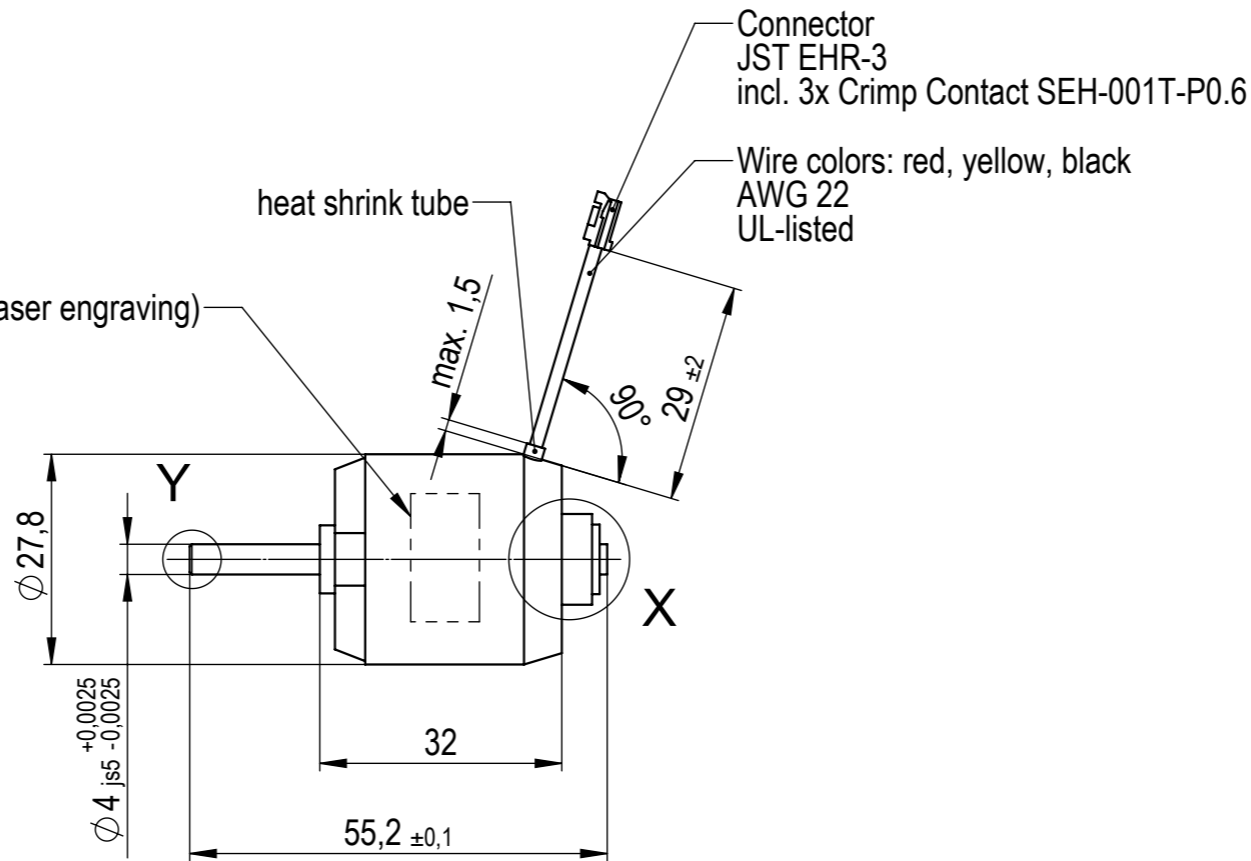

Ball Bearing
NMB Part Number:
L-940ZZMTR P5P24LY121
Class: JIS - 5

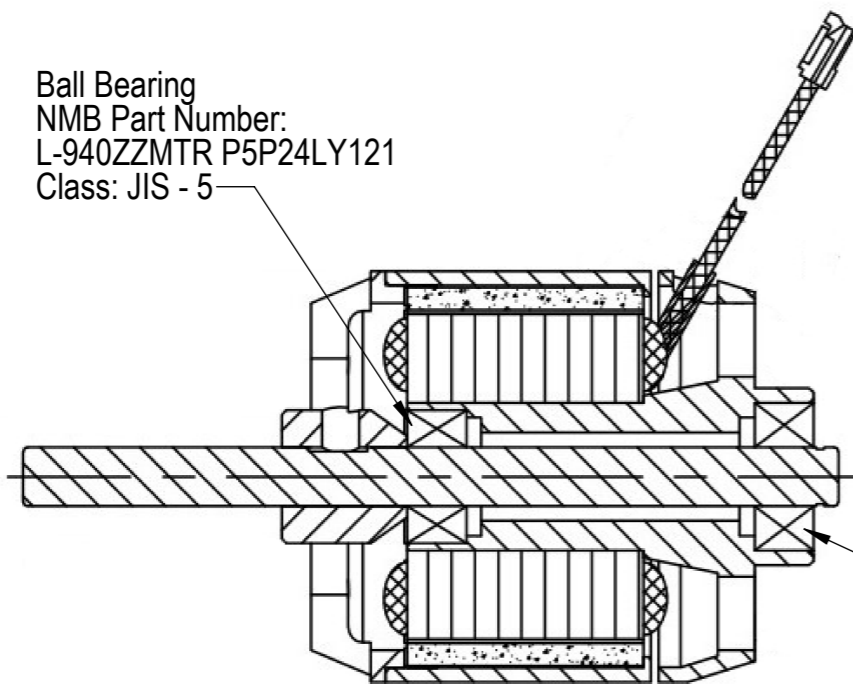

Ball Bearing
NMB Part Number:
L-1040X2ZZR
Class: JIS - 5

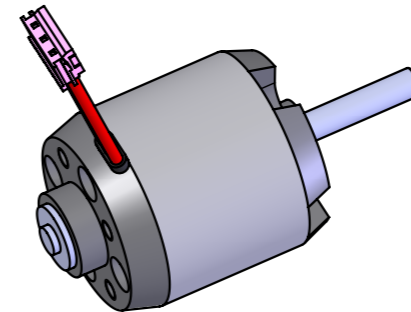

Coat of copper wire UL-listed
Shrink tube UL-listed
Insulation of stator UL-listed
Wire UL-listed

Voltage: 7.2V
I_{max}: 5A

Torque:
starting load: 50mNm
permanent load: 28mNm

Speed:
3000min⁻¹ at 6.8V and 50mNm
kV: 550-600n/V

Datum / date 15.01.2020	Gezeichnet / design Bro	Geprüft / checked	Werkstoff / material	Masstab / scale 1:1	Projection mm 	Ersatz für / replacement for P0306-21
Geändert / changed A 24.03.20 / Bro	F	K	Merkmale / features	Benennung / description Motor BDC (G) Schermaschine Opal		
B 19.06.20/1390	G	L				
C 11.08.22/1469	H	M				
D	I	N				
E	J	O				
				Zeichnung Nr. / drawing no. C 709-190		

Packing data sheet / packing instructions

709-190

Motor BDC Opal

Mechanical protection:	
Bulk material:	
Blister/Fan:	x
Foil:	
Cushion Film:	
Paper:	
Cardboard:	x
Chips:	

Rust Protection:	
Oiling according to drawing:	
Anti-rust Paper:	
Bag:	

ESD:	
Bag:	
Box:	

Packaging Type:	
Cardboard box:	x
Box 300 x 400 x 145 mm printed:	
Box 300 x 400 x 145 mm embossed:	
Box 400 x 600 x 145 mm:	
Box 400 x 600 x 280 mm:	
Reusable container supplier:	
Euro Pallet:	
Euro Pallet/Frame:	
Euro Pallet/Cover:	
Disposable pallet stable:	
Disposable pallet 1.2x0.8 m stable:	

Package size:	
Weight:	
Volume:	
Quantity per pallet:	
Quantity per package:	180
Quantity per layer:	36
Number of layer:	5
Labeling:	

Remarks:

Important notes:

- Imprint/label on the packaging
- Goods must not oxidize
- Our item number
- Your item number
- Production date
- Quantity

Information:

Empty fields are not relevant for this article

Picture 1



Picture 2

